

# FOR SALE

## RESIDENTIAL - APARTMENT 592SQFT (55SQM) / CALL FOR PRICE!

+65 9696 3350



2 - Bedroom Premium

### TYPE B1

592 sqft  
Block 15 #02-05 to #05-05  
Block 21 #02-19 to #05-19 (interior)  
Block 23 #02-25 to #05-25

### TYPE B1-G

592 sqft  
Block 15 #01-05  
Block 21 #01-19\* (interior)  
#01-20\*  
Block 23 #01-25  
Block 25 #01-28

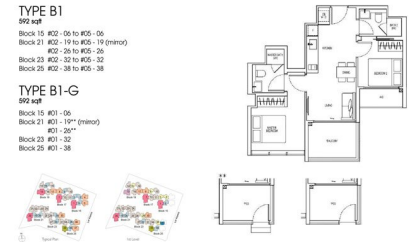

## RESIDENTIAL - APARTMENT

15, 17, 19, 21, 23, 25 LORONG KISMIS, UPPER BUKIT  
TIMAH, SINGAPORE 598008

- LISTING ID: SGLD13613843
- TENURE: LEASEHOLD 99
- TITLE: N/A
- SIZE BUILT-UP: 592SQFT (55SQM)
- SIZE LAND: 3.212AC (1.300HA)
- NO. OF FLOORS: 5
- FLOOR/LEVEL: N/A - N/A
- BED ROOMS: 2
- BATH ROOMS: 2
- MAIDS ROOMS: N/A
- PARKING SPACES: N/A
- LAYOUT TYPE: OTHER
- FACING: N/A
- VIEWING: OTHER
- SELLING PRICE: **CALL FOR PRICE!**
- COMPLETION YEAR: 2023
- CONDITION: ORIGINAL CONDITION
- FURNISHING: PARTIALLY FURNISHED
- LISTING DATE: APR 27, 2021

## VIEW AT KISMIS

Partially furnished, 2 bedroom, 2 bathroom Apartment for Sale. Completed in 2023, this unit is in original condition. Others: Leasehold 99 Located in Singapore's district D21 near Clementi Park, Upper Bukit Timah in the area Central West (Central region).

## INTERIOR FACILITIES

- Balcony

## OTHER INTERIOR FEATURES

- Cooker Hob/Hood
- Fridge
- Oven / Microwave
- Washing Machine

## EXTERIOR FACILITIES

- 24 Hours Security
- Clubhouse
- Covered Car Park
- Landscaped Garden

VISIT THIS PROPERTY AT: <https://www.kwekgermaine.com/property/SGLD13613843>



## GERMAINE KWEK - HUTTONS ASIA PTE LTD

3 Bishan Place #05-01 CPF Bishan Building  
D20, 579838, Singapore

+65 9696 3350  
WhatsApp Me

info@kwekgermaine.com

L3008899K  
R006904G

<https://www.kwekgermaine.com>



Scan QR Code

**Huttons** Call for Viewing  
The Agency of Choice +65 9696 3350